

CMT300

Max Length 305 mm
Joint Thickness 11~25 mm

Dovetail joints give a lasting symbol of craftsmanship to your work, but many woodworkers avoid the joint due to its apparent complexity. CMT's new 12" Dovetail Jig is the fast, easy solution. With precise templates, permanent stops and easy adjustments, we've taken the "tinkering" out of dovetail joinery. You simply clamp your workpieces in with the edges against the factory-set stops, set your bit depth, and you're ready to rout. We haven't cut any corners on quality either: This jig features steel construction throughout - body, templates, stops and clamping bars - so it will still produce perfect joints long after jigs with lightweight plastic parts have gone to the scrap heap. The jig accepts stock from 7/16" to 1" thick, and is capable of producing a variety of joints with the available templates. The standard jig includes a template for 1/2" half blind joints, a template guide (some routers require adapter, see below), a CMT carbide tipped dovetail bit and complete instructions. Optional templates are also available for through-dovetail and box joints.

Rugged steel
Templates

Closed-section
steel clamping bars

Factory-preset stops

Massive steel Body
provides solid support

Easy-to-grid
Handles

For More Information:
Call WOOD TECH
1-800-TOOLING
8 a.m. to 5 p.m. EST

Standard equipment

- Standard blind template Ø12,7 mm silver color **CMT300-T128**
- Bearing kit for shank router bits
- Template guide Ø15,8x4 mm **899.005.00**

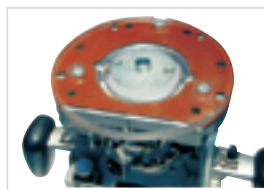

Universal router base

(Shank=Ø8 and 12 mm)
(Shank=Ø6,35 and 12,7 mm)

CMT300-SB1
CMT300-SB2

Will the template guide fit my router?

The guides attach using two screws spaced 2" on center. Many routers accept this design. If your router does not, order the Universal Base listed above.

Here's how it works:

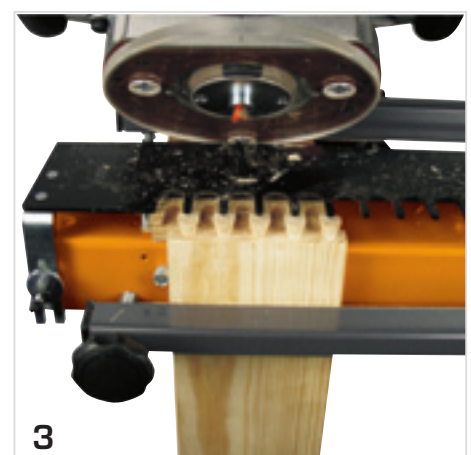

Half blind template

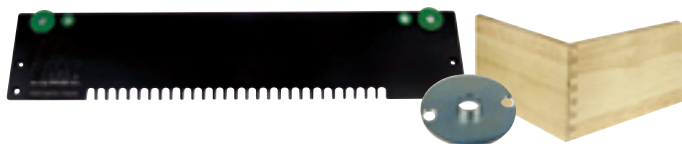

Template length mm	Dovetail size mm	Thickness mm	Color	ORDER NO.
300	6,3	8 ~ 12	green	CMT300-T064

Supplied with precision guide Ø7,8x4mm

899.003.00

To be used with CMT dovetail router bits:

Bit HW Ø6 x 8 mm (shank Ø6mm)

718.060.11

Bit HW Ø6,35 x 8,3 mm (shank Ø6,35 mm)

818.064.11

Box joint template

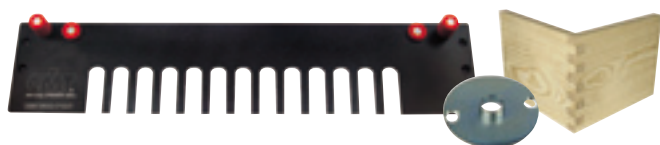

Template length mm	Dovetail size mm	Thickness mm	Color	ORDER NO.
300	8	8 ~ 20	blue	CMT300-T080

Supplied with precision guide Ø11,1x4 mm

899.004.00

To be used with CMT straight router bits:

Bit HW Ø8 x 25 mm (shank Ø6,35mm)

811.081.11

Bit HW Ø8 x 30 mm (shank Ø8 mm)

912.080.11

Template length mm	Dovetail size mm	Thickness mm	Color	ORDER NO.
300	12,7	8 ~ 20	red	CMT300-T127

Supplied with precision guide Ø15,8x4 mm

899.005.00

To be used with CMT straight router bits:

Bit HW Ø12,7 x 30 mm (shank Ø6,35mm)

812.127.11

Bit HW Ø12,7 x 25 mm (shank Ø12,7 mm)

811.627.11

Through dovetail template

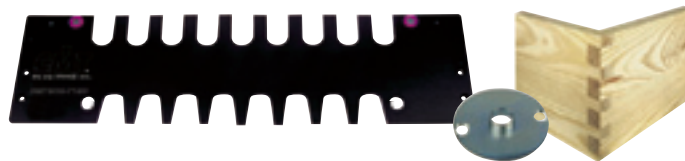

Template length mm	Dovetail size mm	Thickness mm	Color	ORDER NO.
300	12,7	8 ~ 20	brown	CMT300-T129

Supplied with precision guide Ø11,1x4 mm

899.004.00

To be used with CMT straight router bits:

Bit HW Ø8 x 25 mm (shank Ø6,35mm)

811.081.11

Bit HW Ø8 x 30 mm (shank Ø8 mm)

912.080.11

To be used with CMT dovetail router bits:

Bit HW Ø12,7 x 20 mm (shank Ø6,35mm)

818.129.11

Bit HW Ø12,7 x 20 mm (shank Ø8 mm)

918.129.11

Template length mm	Dovetail size mm	Thickness mm	Color	ORDER NO.
300	19	15 ~ 25	violet	CMT300-T190

Supplied with precision guide Ø22x4 mm

899.006.00

To be used with CMT straight router bits:

Bit HW Ø12,7 x 30 mm (shank Ø6,35mm)

812.127.11

Bit HW Ø12,7 x 25 mm (shank Ø12,7 mm)

811.627.11

To be used with CMT dovetail router bits:

Bit HW Ø19 x 22 mm (shank Ø6mm)

718.190.11

Bit HW Ø19 x 22 mm (shank Ø6,35mm)

818.190.11

Bit HW Ø19 x 22 mm (shank Ø8mm)

918.190.11

Bit HW Ø19 x 22 mm (shank Ø12mm)

918.690.11

Bit HW Ø19 x 22 mm (shank Ø12,7mm)

818.690.11

Precision guide for router:

7,8 x 4 mm	899.003.00
11,1 x 4 mm	899.004.00
15,8 x 4 mm	899.005.00
22 x 4 mm	899.006.00



Here are a few of the beautiful dovetail joints you can produce using CMT bits

1/2" Half Blind
(included)

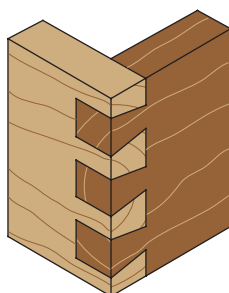

1/2" Through
Dovetail

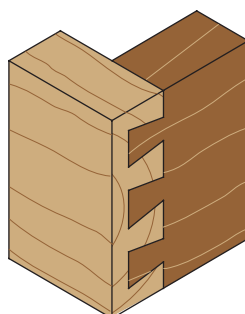

5/16" or 1/2"
Box Joint

