

DA 10



Digital Position Indicator for larger spindles.

Options

- Special pitches
- mm/inch: display of metric pitches in Inch. The entire value is used for internal calculation, but not displayed. Display value and additional calculation values are separated by „/“. Example: 4 mm = 0.15748 Inch; Display value 00.15; additional figures for calculation .../ 748
- Mineral glass viewing window, solvent resistant
- Reducing sleeves to adapt to various spindle diameters.
- Axial seal (dust-proof)

For Ordering Information, contact:
Wood Tech Enterprises, Inc.
1-800-Tooling (866-5464)

or 1.828.628.4414
Fax: 1.828.628.4490

Technical data

Counter:	5 decades, vernier scale
Digit size:	approx. 6 mm
Hollow shaft [ø mm]:	30 ^{H7} or 25 ^{H7}
Housing:	High Impact Polyamid 6
Weight:	0.1 kg

Colours:	orange RAL 2004 black RAL 9005
Ambient temperature:	+ 80°C max.

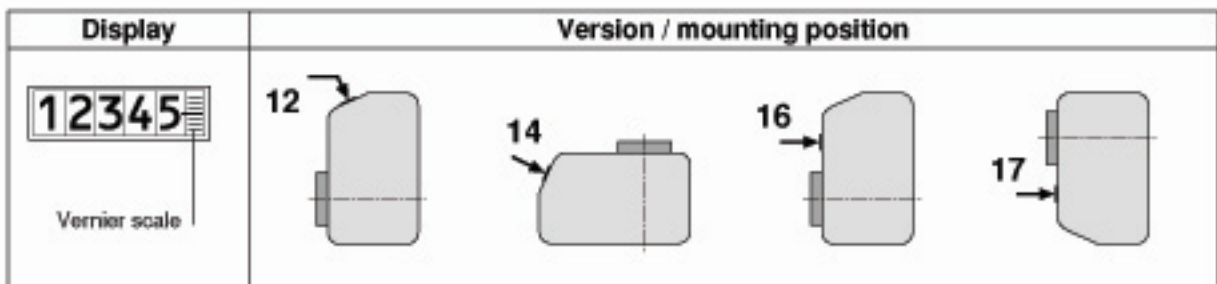

Pitch (mm)	Display after 1 revolution (comma position)			Max. speed (r/min)
1	0001.0	000.10	00010	1500
1.5	0001.5	000.15	00015	1000
2	0002.0	000.20	00020	750
2.5	0002.5	000.25	00025	600
3	0003.0	000.30	00030	500
4	0004.0	000.40	00040	450
5	0005.0	000.50	00050	300
6	0006.0	000.60	00060	250
8	0008.0	000.80	00080	180
10	0010.0	001.00	00100	150

Note: Speeds above >500 r/min for short periods only. Other spindle pitches on request.

DA 10

For Ordering Information, contact:
 Wood Tech Enterprises, Inc.
 1-800-Tooling (866-5464)
 or 1.828.628.4414
 Fax: 1.828.628.4490

SIKO Digital Position Indicator

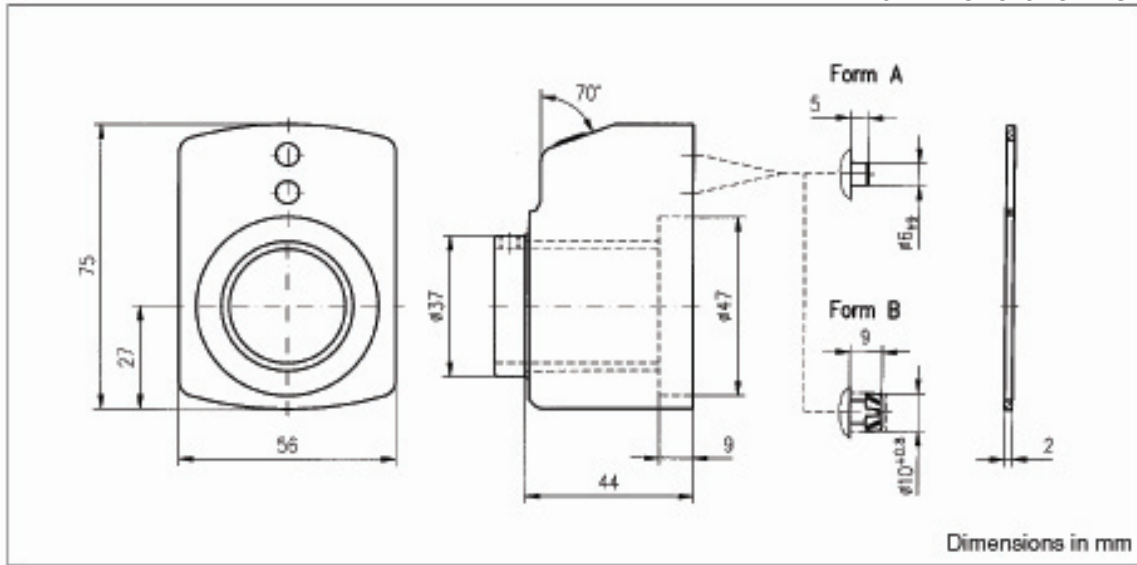

Hollow shaft design	Torque pin position	Count. direction

Reducing sleeve	Axial seal
<p>$\varnothing d^{17} = 16, 20, 22, 24, 25, 26$</p>	<p>See mounting instructions!</p>

Ordering code **DA 10 - 1** - [] - [] - [] - [] - **RH** - [] - [] - [] - []

Type DA10

Version / mounting position

Display after one revolution

Decimal places 0 to 4
 Eg. 0 = 0000 1 = 000.0 2 = 00.00

Counting direction
 I = clockwise increasing, E = counter-clockwise increasing

Hollow shaft bore
 30^{H7} (standard), < 30 use reducing sleeve RH... (see table on page 24)

Colour of housing
 O = orange (standard), S = black

Hollow shaft design
 WK = type short (standard) or WL = type long

Torque pin
 A = type A (standard), or type B

Torque pin position
 I = position I (standard) or position II

Axial seal
 0 = without (standard), 1 = with